

**Hardware**  
Use the (4) screws and (4) nuts to attach the platform to the articulating arm (see diagram).





**Cord Clips (Not Shown)**  
Peel off backing and adhere to underside of platform to assist with mouse cord management.

**INSTALLATION**

**HARDWARE DO NOT DISCARD**

**Keyboard Platform Installation Instructions**

**Included Hardware for:**

- |   |  |   |
|---|--|---|
| <b>P-Series</b><br>1/4" Platform Material | <br>4 Nuts<br>#8 - 32 | <br>4 Screws<br>#8 - 32 x 1/2 in |
| <b>V-Series</b><br>1/2" Platform Material | <br>4 Nuts<br>#8 - 32 | <br>4 Screws<br>#8 - 32 x 3/4 in |

Customer Service: 800.833.3746 (ERGO)  
 Factory: 480.517.1871  
 Fax: 480.517.1872  
 Web Site: www.esiergo.com  
 E-mail: info@esiergo.com

Customer Service: 800.833.3746 (ERGO)  
 Factory: 480.517.1871  
 Fax: 480.517.1872  
 Web Site: www.esiergo.com  
 E-mail: info@esiergo.com

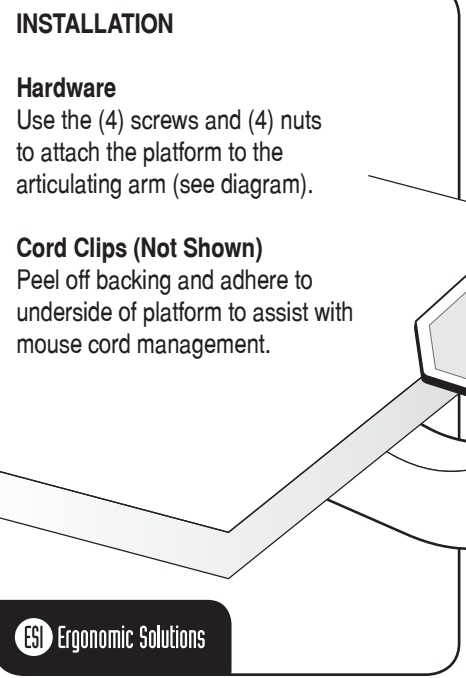

**INSTALLATION**





**Hardware**  
Use the (4) screws and (4) nuts to attach the platform to the articulating arm (see diagram).

**Cord Clips (Not Shown)**  
Peel off backing and adhere to underside of platform to assist with mouse cord management.

**HARDWARE DO NOT DISCARD**

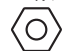
**Keyboard Platform Installation Instructions**

**Included Hardware for:**

- |   |  |   |
|---|--|---|
| <b>P-Series</b><br>1/4" Platform Material | <br>4 Nuts<br>#8 - 32 | <br>4 Screws<br>#8 - 32 x 1/2 in |
| <b>V-Series</b><br>1/2" Platform Material | <br>4 Nuts<br>#8 - 32 | <br>4 Screws<br>#8 - 32 x 3/4 in  |