

ASSEMBLY INSTRUCTIONS

Elevate™ Wrap, Electric Lift Table



Product	Part#
ELT Wrap	ELTAWRzz/xx4



Anthro Corporation® | 10450 SW Manhasset Dr. | Tualatin, OR 97062
Toll-free: 800.325.3841 | Fax: 800.325.0045 | email: sales@anthro.com | anthro.com
Outside the U.S. | Tel: 503.691.2556 | Fax: 503.691.2409

April 2007 Rev. A

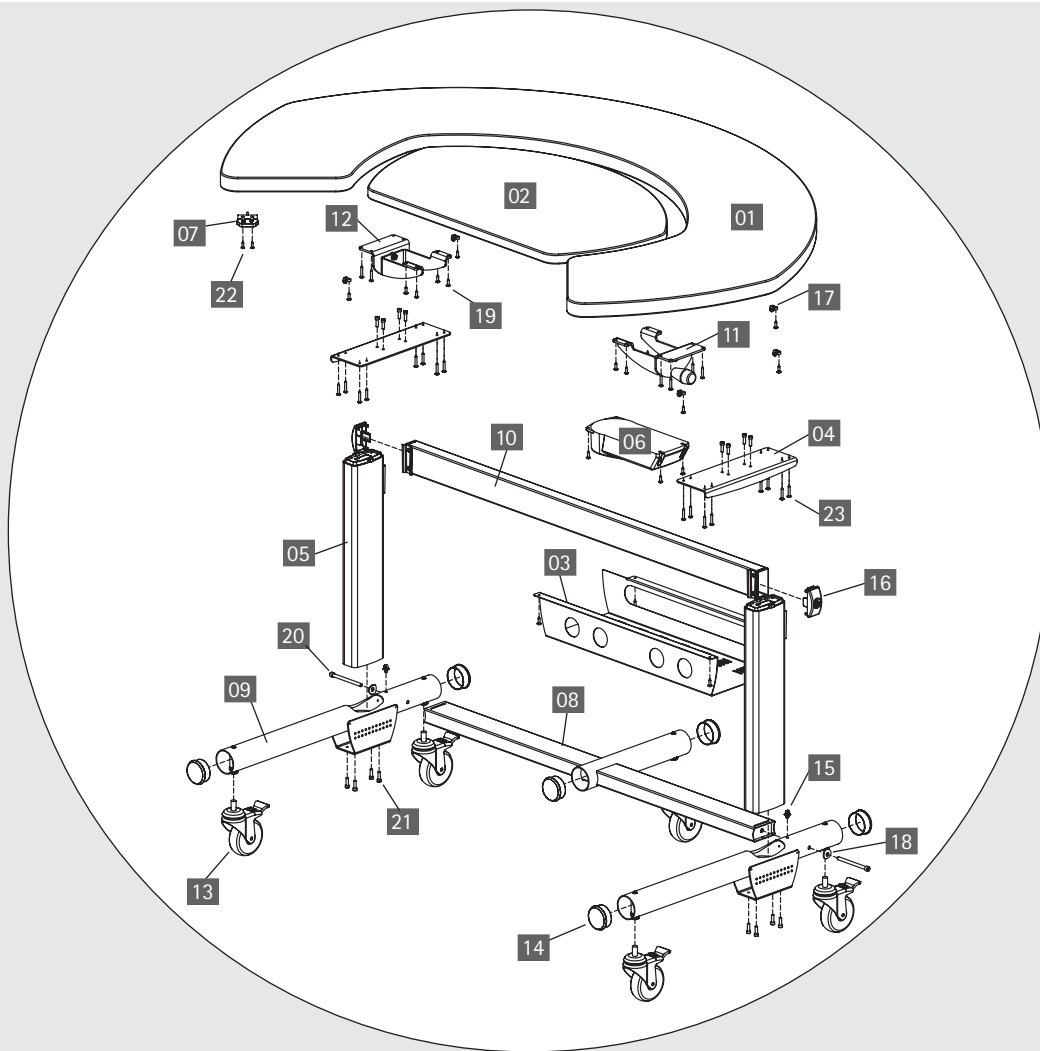

WELCOME

Thank you for purchasing the Elevate™ Wrap! If you have any questions or if we can help you in any way, please contact us at 800.325.3841.

This assembly requires two people.

PARTS LIST

Before beginning assembly of your Wrap, please take a moment to review the parts listed below to verify that your shipment is complete.

A Phillips head screwdriver is required (but not provided) for this assembly. The assembly will go more quickly if you use a power driver. Be sure to set the torque to about 3/4 power to avoid stripping the screws.

Product	Quantity	Part Number
01 Monitor Shelf	1	100-6563-zz
02 Keyboard Shelf	1	100-6564-zz
03 Cable Trough	1	225-2278-zz
04 Gusset	2	225-2279-zz
05 Leg	2	575-5018-zz
06 Control Box	1	400-5153-00
07 Keypad	1	400-5175-00
08 Cross Tube	1	500-1003-zz

09 Base Tube	2	500-1006-zz
10 Cross Bar	1	500-1011-zz
11 Tilter with Knob	1	835-5105-00
12 Tilter without Knob	1	835-5106-00
13 4" Locking Caster	5	150-5065-00
14 Basetube End Cap	6	175-5158-32
15 Cable Clip	2	175-5188-00
16 Cross Bar End Cap	2	175-5190-32
17 Cable Tie	5	400-5152-00
18 Basetube Washer	2	225-3522-00
19 3/4" Wood Screw	21	325-5106-00
20 4" Cap Screw	2	325-5166-00
21 20mm Socket Head Cap Screw	16	325-5272-00
22 3/4" Phillips Screw	2	325-5370-00
23 1-1/4" Button Head Screw	24	325-5178-00
24 Hex Driver (not shown)	1	375-5000-00
25 1/4" Hex Key (not shown)	1	375-5024-00
26 Rubber Mallet (not shown)	1	375-5022-00
27 5mm Hex Key (not shown)	1	375-5014-00
28 5/32" Hex Driver Bit (not shown)	1	375-5003-00
29 10' Power Cord (not shown)	1	400-5181-00
30 1m Control Box Cable (not shown)	2	400-5182-00

STEP 1

Attach the Legs to the Base Tubes

- Hold one leg so the Slot is facing away from you and the cord is coming out the top. Route the leg cord through the notch on the top. Using the mallet, firmly attach the cord grommet to the notch. Make sure that one leg has the cord on the left and one leg has the cord on the right.
- Align a leg with the opening on the base tube so that the slot on the legs is facing the hole on the base tube and that the cord comes out the top.
- Attach with four Socket Head Cap Screws.
- Repeat for the second leg.

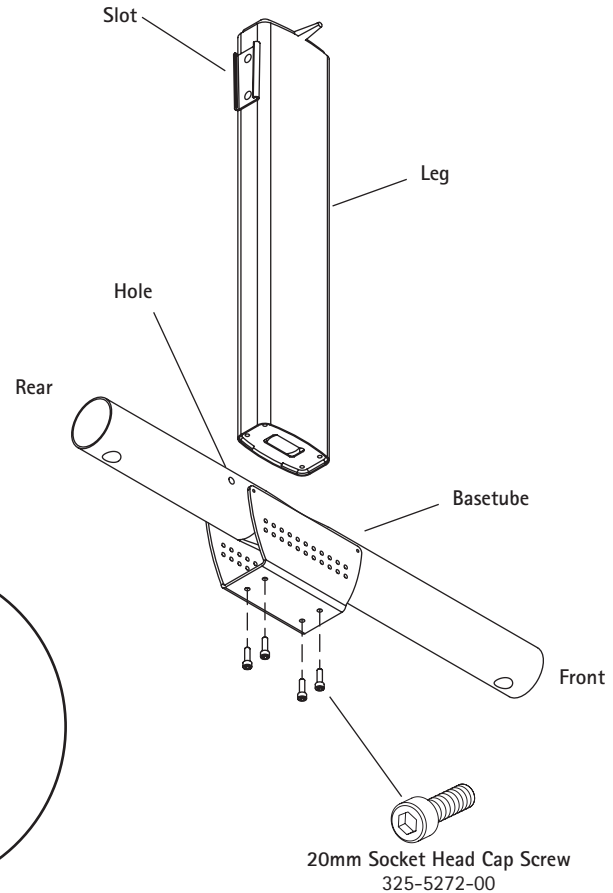
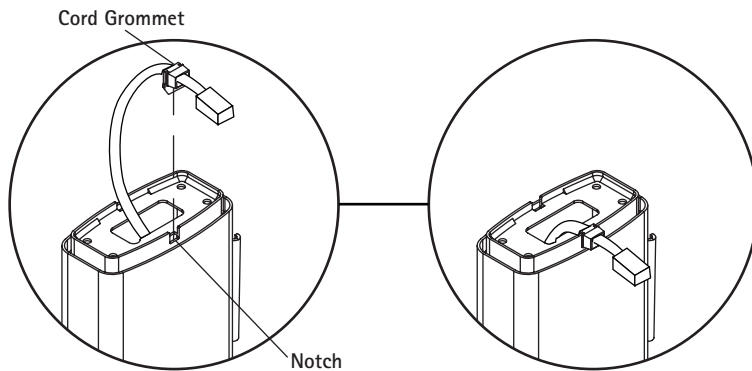

STEP 2

Attach Gusset to Legs

- Align a gusset with a leg assembly so that the side flange on the gusset goes on one side and the cord goes on the inside. Install the gusset onto the leg with four Socket Head Cap Screws.
- Repeat for the second leg. Now you have a left leg and a right leg.

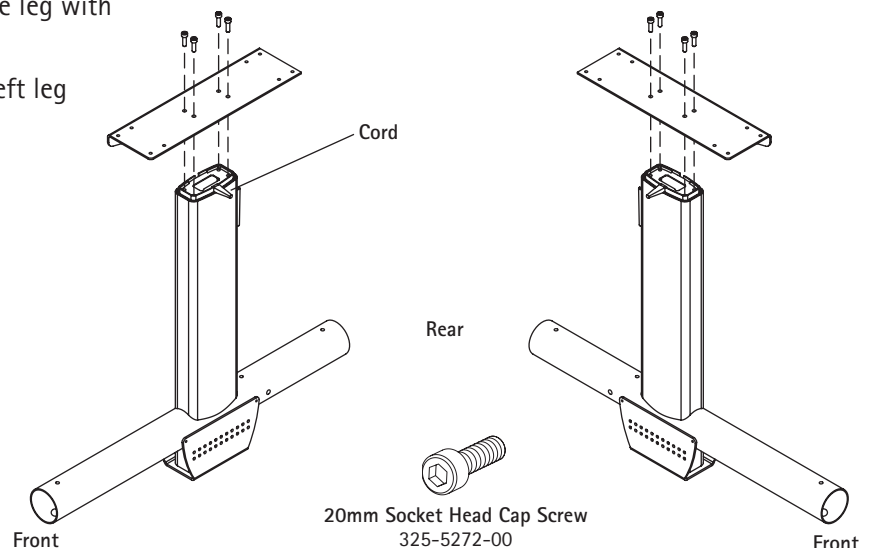

STEP 3

Attach Leg Assembly to Shelf

- Set the top of the cap screws into the large holes in the shelf. Align the holes on the gusset with pre-drilled holes on the shelf. Attach each leg with eight Wood Screws.

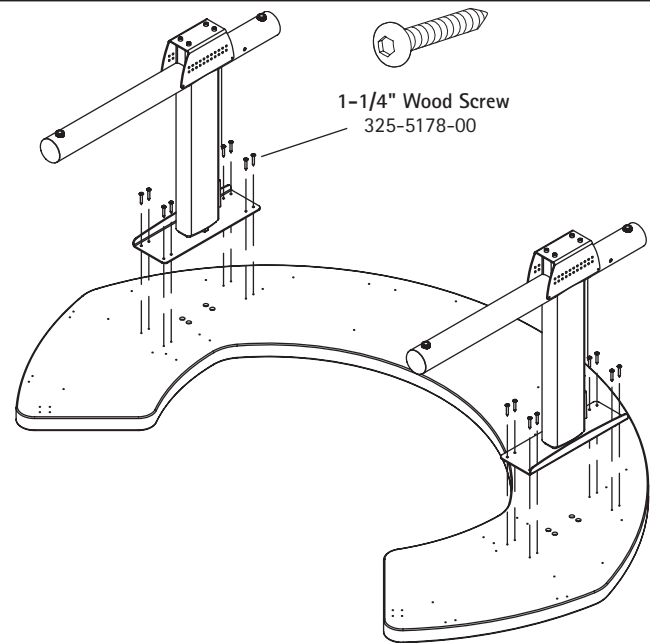

STEP 4

Attach Control Box and Keypad

- Align the Control Box with the pre-drilled holes at the back of the Main Shelf making sure that the cord outlets are at the back. Secure with four wood screws.
- Using two Phillips Head Screws, attach the Keypad to the front of the Wrap. The Keypad can be installed on the left side or the right side, and it can be installed with the buttons hidden or with the buttons visible.
- Plug the leg cords into the Control Box. Plug the Keypad cord into the Control Box. Tie down the cords using Cable Ties at the positions indicated.

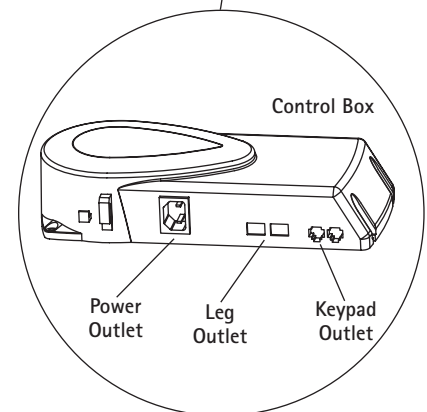
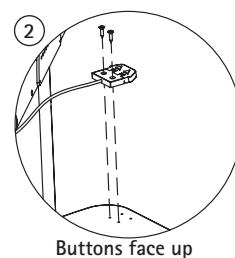
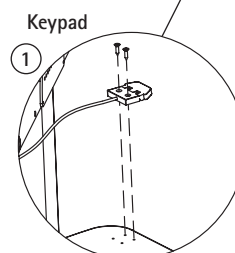
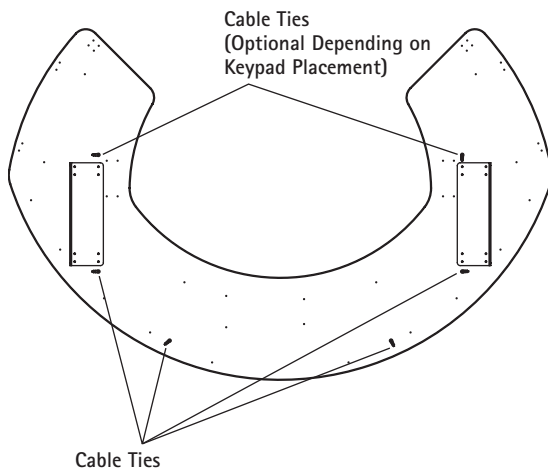
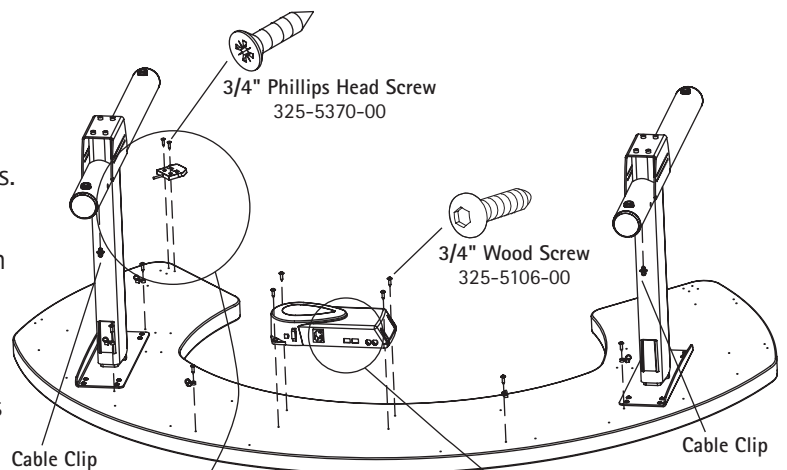

STEP 5

Add Cable Trough

- Align the Cable Trough with the pre-drilled holes on the shelf. Before installing the trough, make sure that cables are routed through the ends of the trough. Secure the Trough to the shelf using four Wood Screws.

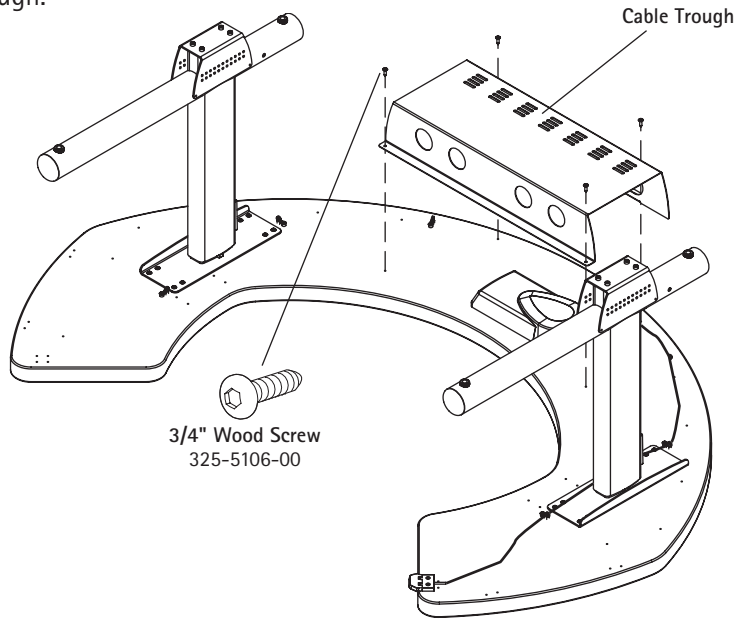

STEP 6

Add Cross Tube Assembly and Casters

Note: This is a two-person step!

- While one person holds the Cross Tube assembly in line with the right leg assembly, the other installs one Cap Screw and Curved Washer through a side hole, carefully threading the screw into the Cross Tube, but do not tighten all the way. Repeat for the other side, then tighten both Cap Screws.
- Thread casters into the caster inserts in each leg. This is a lot easier if you lock the casters first.

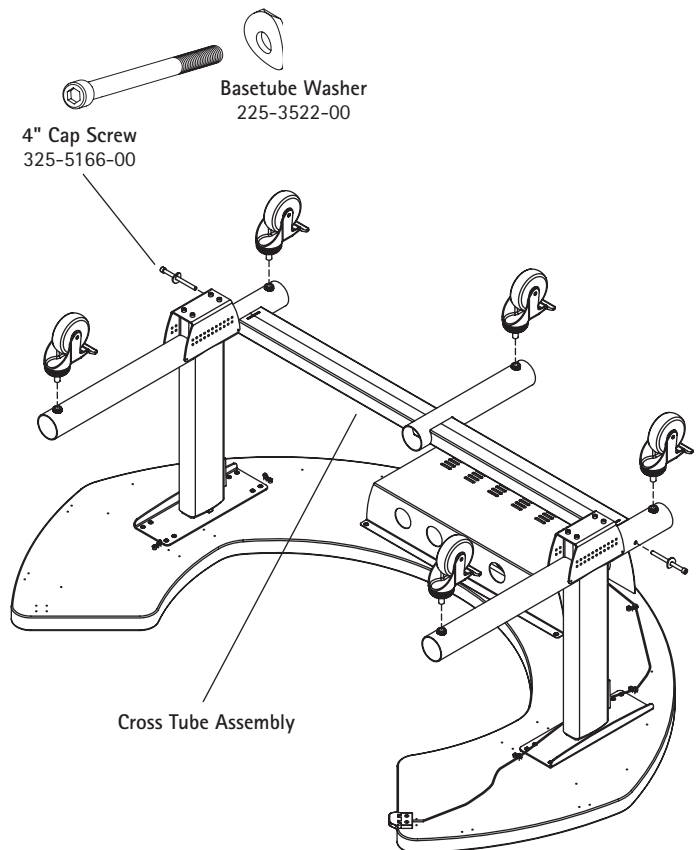

STEP 7

Install Keyboard Shelf

- Align the Tilt Brackets with the pre-drilled holes on the Keyboard Shelf. Make sure that the bracket with the knob is on the left. Attach the Brackets to the Shelf with 3/4" Wood Screws. (Don't use the 1-1/4" Wood Screws because the shelf is 1" thick!)
- Place Keyboard Shelf onto center of Main Shelf
- Attach the Keyboard Shelf assembly to the Main Shelf with 1-1/4" Wood Screws.

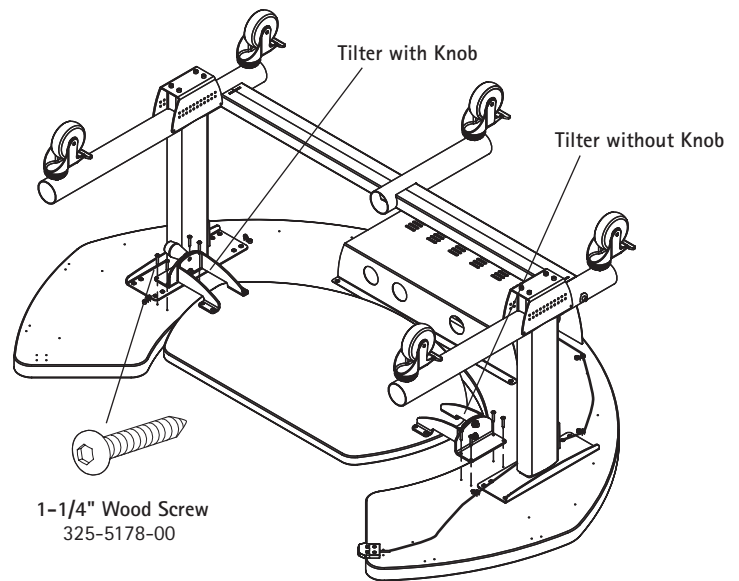
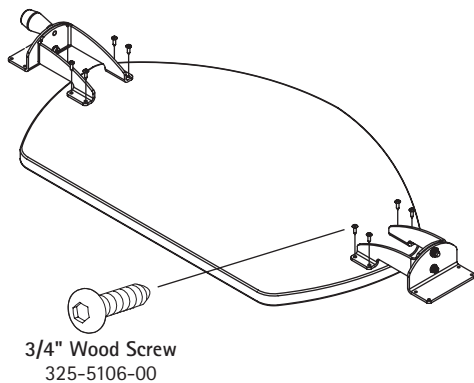

STEP 8

Turn Table Right Side Up and Plug in Power Cord

- With the help of another person, carefully rotate the Wrap onto its casters.
- Plug the power cord into the Control Box and an outlet. Route power cord through a cable clip at the base of one leg.

STEP 9

Install Cross Bar

- Using the Keypad, move the Wrap all the way up. Check the legs for excess lubricant and wipe down if needed. If you push the button and the legs don't go, make sure that all the cord connections are secure, unplug the power cord, wait 10 seconds, plug the power cord back in, and try the button again.
- Align the Cross Bar so that the tapered ends of the cross bar brackets line up with the leg brackets. Using the mallet, drive the Cross Bar completely into place (a few whacks on the left, a few on the right, then left, then right...).

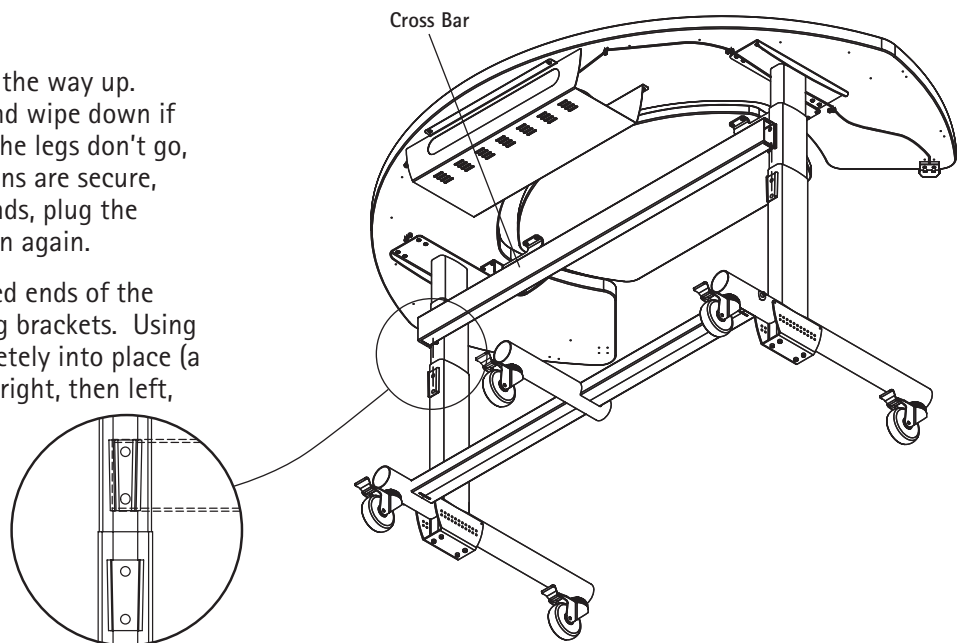

STEP 10

Insert End Caps

- Pop end caps into Cross Bar and Base Tubes. Use the mallet to set them into place.

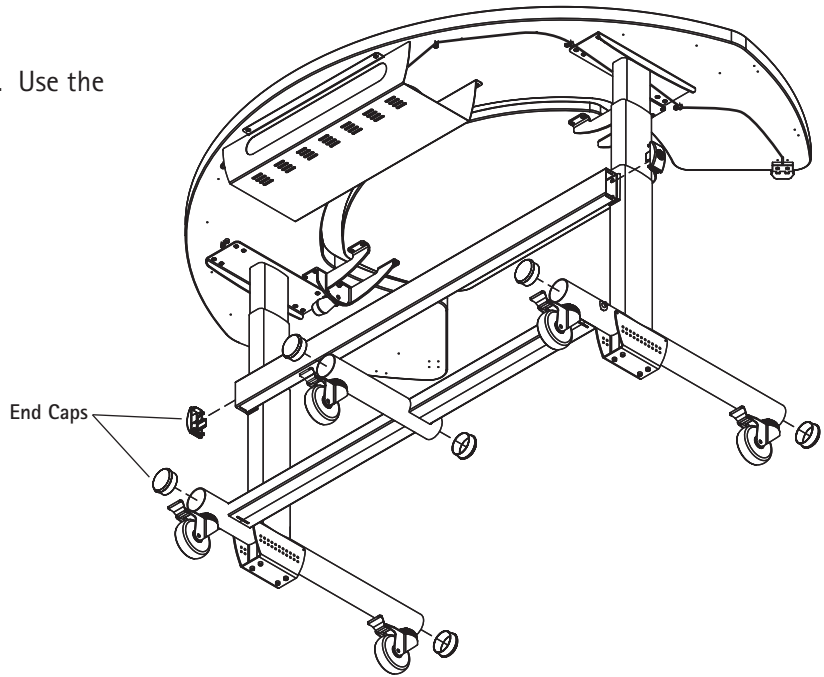

STEP 11

Home Legs

- Press the Down button on the Keypad three times, and hold down on the third time for about 5-10 seconds until you hear a slight click and the table bumps up-down-up.
- If the legs fail to function properly, unplug the power, wait 10 seconds, plug the power back in and repeat the above step.
- Legs must also be homed any time power is disconnected from the legs.

STEP 12

Install Equipment and Test Cord Lengths

- If you've purchased any other Anthro accessories, add them now. Install your own equipment now, too.
- A word of caution: the height range of the Elevate Wrap may be longer than the cords on your equipment. Equipment that is mounted in a SideRack or Equipment Shelf, for example, will not move up and down with the table, so raise and lower the table to its highest and lowest positions when all equipment is installed to make sure that cords are long enough.
- Adjust the tilt of the Keyboard Shelf. First use the knob to loosen by turning it toward you. Now push on the shelf to find the right tilt for you, then tighten the knob by turning it away from you.

Congratulations! Your assembly is complete!



Anthro Corporation® | 10450 SW Manhasset Dr. | Tualatin, OR 97062
Toll-free: 800.325.3841 | Fax: 800.325.0045 | email: sales@anthro.com | anthro.com
Outside the U.S. | Tel: 503.691.2556 | Fax: 503.691.2409



Warranty:

The Table has a Lifetime Warranty. The electrical has a one year Warranty. The power cord is not covered under Warranty.

Notices:

Technology Furniture™ and Elevate™ are trademarks of Anthro Corporation. Anthro reserves the right to modify the design and specifications without prior notice.